



Eastbound and Westbound US 36 Weekend Traffic Realignment

Nov. 21-23

As part of the US 36 Express Lanes Project, eastbound and westbound US 36 from Federal Boulevard to Wadsworth Parkway will be placed into a temporary traffic alignment starting Saturday, Nov. 21, at 9 a.m. through Monday, Nov. 23, at 5:30 a.m. This alignment is necessary to complete pavement repair work. Traffic will be realigned into a new configuration using the Express Lanes as free general purpose lanes.

Current Traffic Alignment



Weekend Temporary Alignment

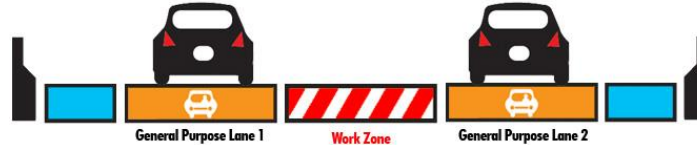

Eastbound Traffic Alignment:

- Eastbound traffic will be realigned into a split-lane configuration from Interlocken to Wadsworth Parkway.
- The Express Lane will be used as a free general purpose lane.
- All tolls will be waived during construction activity in the designated work zone.

Westbound Traffic Alignment:

- Westbound US 36 traffic will be realigned into several different split-lane configurations from Federal Boulevard to 88th Street.
- The Express Lane will be used as a free general purpose lane.

All tolls will be waived during construction activity in the designated work zone. All on- and off-ramps will remain open and unobstructed. This modified lane configuration will allow two through lanes with one lane being closed during daytime hours from 9 a.m. - 10 p.m. After 10 p.m., traffic will be reduced to a single lane in both directions. Delays should be expected and additional travel times should be anticipated. For more information go to www.us36expresslanes.com or call 303-404-7042.



COLORADO
Department of
Transportation

